

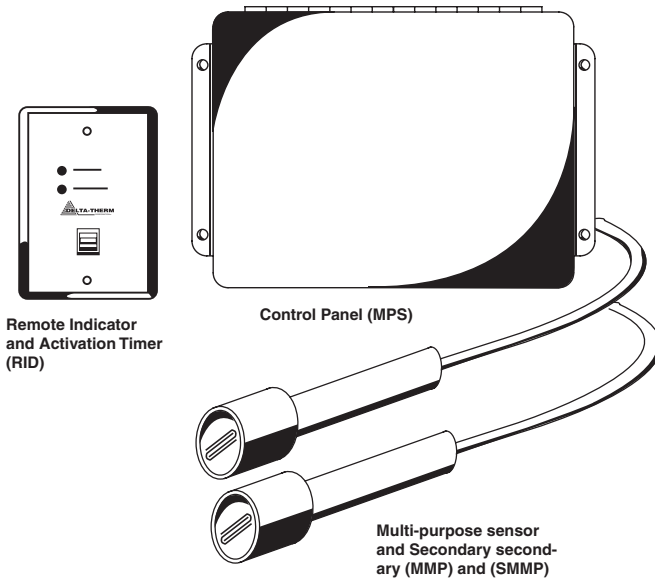

MPS SNOW MELT CONTROL SYSTEM

The MPS is designed to detect snow or ice and automatically activates a snow melting cable or mat.

C
O
N
T
R
O
L
S



100% Factory Tested

**Locate Control Panel
Indoors or Outdoors**

**Versatile Sensor Mounting and
Placement**

Automatic Start and Stop

No Operator Adjustments

**Optional Remote Indicator and
Activation Timer**

Optional Secondary SMMP Sensor

Approximate Component Dimensions

MPS Control Panel: 8.5" (21.59 cm) W x 6.5" (16.51 cm) H x 5.0" (12.7 cm) D

MMP Sensor: 2.0" (5.08 cm) dia. x 8.0" (20.32 cm) L

MP Sensor: 5.0" (12.7 cm) dia. x 5.0" (12.7 cm) L

RID: 2.75" (6.99 cm) H x 4.5" (11.43 cm) W



UL Listed

SYSTEM COMPONENTS

The MPS control system consists of a NEMA 4 control panel (MPS) with a 24 AMP N.O. (Normally Open) relay output contact and a temperature/moisture sensor (MMP). For larger amp loads the relay output can also be used to activate contactors.

A low voltage 6-conductor cable connects the MPS control panel to the MMP sensor. All cable leads are color coded for ease of field wiring.

MPS Location

The MPS control panel can be installed outdoors or indoors. The MPS control panel can attach directly to the MMP or can be remotely located using optional extension wire to connect to the MMP.

The MMP sensor can attach directly to the MPS enclosure and be installed next to a drive or walk area, or the MMP sensor can be installed alone in an area indicative of snow fall. Do not locate the MMP sensor under trees awnings, next to a structure, or in any location which may be blocked from snow.

Optional Secondary Moisture Sensor (SMMP)

The optional SMMP moisture sensor is used to sense moisture at a different location from the MMP.

The SMMP works in conjunction with the MMP. If the ambient temperature at the MMP is below approximately 35F, then the presence of moisture at either sensor will activate the system.

MAINTENANCE

The only field maintenance required is surface cleaning of the MMP or SMMP sensor prior to the winter season. Washing the sensor with a mild soap solution and bristle brush will remove oil, dirt, or any other foreign substance that may have accumulated.

SYSTEM OPERATION

The MPS control panel continually checks conditions at the MMP sensor. The following two conditions activate the snow melting system:

1. Ambient temperature at the MMP sensor is below approximately 35°F (1.7° C).
2. Snow or moisture is present on the MMP sensor.

When the snow melting system is operating and the MPS senses that one of the two conditions at the MMP sensor ceases to exist, the MPS 5-hour timer activates. Once the timer is activated, the snow melting system operates for 5 hours, and then shuts off. When the two conditions reoccur at the MMP sensor, the snow melting system reactivates.

If the snow melting system is operating on the 5-hour timer and the two conditions at the MMP sensor reoccur, the timer deactivates while the snow melting system continues operating. When one of the two conditions at the MMP sensor ceases to exist, the MPS 5-hour timer reactivates. Once the timer is reactivated, the snow melting system operates for 5 hours, and then shuts off. When the two conditions reoccur at the MMP sensor, the snow melting system reactivates.

Optional Remote Indicating Device (RID)

An optional remote indicator and activation timer (RID) can be mounted up to 100 feet (30.48 m) from the MPS control panel.

The RID switch can manually activate the snow melting system on the RID's internal 5-hour timer. When the RID activates the melting system; it can also deactivate the melting system if MPS sensors have not called for the snow melting system to be activated.

The bottom indicator light (system on) is on whenever the snow melting is operating.

The top indicator light (timer on) flashes when the snow melting system is operating on the RID timer.



398 W. Liberty St. P.O. Box 345 Wauconda, IL 60084
(847) 526-2407 (312) 346-0053 (800) 526-7887 FAX (847) 526-4456

Email heat@delta-therm.com Internet <http://www.delta-therm.com>